

# Montpellier

DOMESTIC APPLIANCES

LAUNDRY DISHWASHING COOKING COOLING

## Installation & Operating Instructions



Undercounter Larder Fridge in White  
**MDAUCL48W**

Please read these instructions carefully before attempting to install or use this appliance.  
We recommend that you keep these instructions in a safe place for future reference.

# Contents

---

<b>Safety Information</b>	4
<b>Care &amp; Cleaning</b>	6
<b>Product Overview</b>	9
<b>Door Reversal:</b>	10
<b>Space Requirement</b>	13
<b>Temperature Settings</b>	15
<b>Cleaning</b>	16
<b>Moveable Shelves</b>	17
<b>Hints for Refrigeration</b>	17
<b>Troubleshooting</b>	19
<b>Product Specification</b>	20
<b>Here for You</b>	21

## **DEAR CUSTOMER:**

Thank you for buying this product. To ensure that you get the best results from this appliance, please take time to read through the simple instructions in this booklet. Please ensure that the packing material is disposed of in accordance with the current environmental requirements. When disposing of any old appliances please contact your local waste disposal department for advice on safe disposal. This appliance must only be used for its intended purpose.

# Welcome

Thank you for choosing this Montpellier appliance.

Your appliance has been designed to provide you with the best combination of style, reliability and performance, to give you years of trouble-free use.

You may be familiar with a similar product, but please take the time to read these instructions carefully before installing or using your appliance to ensure that you get the most from your purchase and keep the manual for future reference.

The design and specifications are subject to change without prior notice for product development.

## Montpellier

montpellier-appliances.com

# 2 YEAR GUARANTEE

**PARTS & LABOUR**

**ACROSS ALL OUR MODELS**

Your appliance is covered by a comprehensive two year Parts & Labour Guarantee. In the unlikely event that you experience a problem with your appliance, you can rest assured that you are fully protected against the cost of repairs for the first 24 months. Please note that any claim must be accompanied by the model reference number, serial number and proof of purchase.

To activate your guarantee, you will need your product serial number. This can be found inside your appliance.

**NB:** Please make sure that you keep a copy of your original sales invoice as this will be needed if any service call is required.





**There are three ways to register your Guarantee:**

**Online:** Visit the Support page on our website and complete the online Product Registration form.

[www.montpellier-appliances.com](http://www.montpellier-appliances.com)

**By Post:** Simply detach and fill in the form provided, attach a stamp and send it in the post. Don't forget to include your e-mail address so that we can send confirmation through to you.

**By Phone:** Contact our warranty registration department on **08081 961 388**

Icon	Type	Meaning
	Warning	May Cause Serious Injury
	Risk of Electric Shock	Dangerous Voltage Risk
	Fire	Warning, Risk of Fire/Flammable Materials
	Caution	Risk of Damage/ Important Information



## **Safety Information:**

For your safety and to ensure correct use of the appliance, please read this user manual carefully before installation and first use, paying particular attention to the hints and warnings provided.

To avoid unnecessary mistakes or accidents, ensure that all persons using the appliance are fully familiar with its operation and safety features.

Keep these instructions with the appliance at all times. If the appliance is moved or sold, ensure that this manual is passed on to the new user so that they are properly informed about the appliance's operation and safety requirements throughout its service life.

For the protection of life and property, always follow the precautions outlined in this manual. The manufacturer cannot be held responsible for damage or injury resulting from failure to comply with these instructions.

## **Safety of Children & Vulnerable Persons:**

- This appliance may be used by children aged 8 years and above, and by persons with reduced physical, sensory, or mental capabilities, or lack of experience and knowledge, provided they are supervised or have been instructed on how to use the appliance safely and understand the hazards involved.
- Children aged 3 to 8 years are permitted to load and unload this appliance.
- Children should be supervised at all times to ensure they do not play with the appliance.
- Cleaning and user maintenance must not be carried out by children unless they are aged 8 years or above and are supervised.
- Keep all packaging materials well out of the reach of children, as there is a risk of suffocation.
- When discarding the appliance, disconnect it from the mains supply, cut the power cable as close to the appliance as possible, and remove the door to prevent children from suffering electric shock or becoming trapped inside.
- If this appliance, which features magnetic door seals, is replacing an older appliance fitted with a spring lock or latch, ensure that the old locking mechanism is rendered unusable before disposal to prevent it from becoming a hazard to children.

## **General Safety:**



Keep ventilation openings in the appliance enclosure or built-in structure clear of obstruction.



Do not use mechanical devices or other means to accelerate the defrosting process, other than those recommended by the manufacturer.



Do not damage the refrigerant circuit.



Do not use electrical appliances (such as ice cream makers) inside the refrigeration appliance unless they are specifically approved for this purpose by the manufacturer.



Do not touch the light bulb if it has been on for a long period, as it may be very hot. (\*if the product has a light)



When positioning the appliance, ensure that the power supply cord is not trapped or damaged.



Do not place multiple portable socket outlets or portable power supplies at the rear of the appliance.

- Do not store explosive substances, such as aerosol cans with flammable propellants, inside this appliance.
- This appliance contains the refrigerant isobutane (R600a) within the refrigerant circuit. Isobutane is a natural gas with low environmental impact; however, it is flammable.
- During transportation and installation, ensure that no components of the refrigerant circuit are damaged.
- Avoid open flames and sources of ignition.
- Ensure the room in which the appliance is installed is well ventilated.
- It is dangerous to alter the specifications or modify this appliance in any way.
- Damage to the power cord may result in a short circuit, fire, and/or electric shock.
- This appliance is intended for household and similar applications only, including:
  - Staff kitchen areas in shops, offices, and other working environments
  - Farmhouses
  - Use by clients in hotels, motels, and other residential-type environments
  - Bed and breakfast establishments
  - Catering and similar non-retail applications



Any electrical components (plug, power cord, compressor and etc.) must be replaced by a certified service agent or qualified service personnel.



The light bulb supplied with this appliance is a "special use lamp bulb" usable only with the appliance supplied. This "special use lamp" is not usable for domestic lighting. (\*if the product has a light)

- The power cord must not be extended or lengthened.
- Ensure that the power plug is not crushed or damaged by the rear of the appliance. A damaged plug may overheat and present a fire risk.
- Ensure the mains plug remains accessible at all times.
- Do not pull the appliance by the mains cable.
- If the wall socket is loose or damaged, do not insert the plug, as this may cause electric shock or fire.
- Do not operate the appliance without the internal lamp fitted.
- This appliance is heavy; take care when moving it.
- Do not remove or touch items from the freezer compartment with wet or damp hands, as this may cause skin abrasions or frost burns.
- Avoid prolonged exposure of the appliance to direct sunlight.

### **Daily Use:**

- Do not place hot items directly onto plastic components inside the appliance.

- Do not place food items directly against the rear wall of the appliance.
- Frozen food must not be refrozen once it has been completely thawed. (\*if the product has a freezer compartment)
- Store pre-packed frozen food in accordance with the food manufacturer's instructions. (\*if the product has a freezer compartment)
- Always follow the appliance manufacturer's recommended storage guidelines.
- Do not place carbonated or fizzy drinks in the freezer compartment, as pressure may build up and cause containers to burst. (\*if the product has a freezer compartment)
- Ice lollies can cause frost burns if consumed directly from the freezer. (\*if the product has a freezer compartment)
- To avoid food contamination, observe the following hygiene guidelines:
- Avoid leaving the door open for long periods, as this can cause a significant rise in internal temperature.
- Clean all surfaces that come into contact with food regularly, including accessible drainage systems.
- Clean water tanks if they have not been used for 48 hours.
- Flush any water system connected to a mains supply if water has not been drawn for 5 days.
- Store raw meat and fish in sealed containers to prevent contact with or dripping onto other foods.
- Two-star freezer compartments (if fitted) are suitable for storing pre-frozen food, storing or making ice cream, and making ice cubes.
- One-, two-, and three-star compartments (if fitted) are not suitable for freezing fresh food.
- If the appliance is left unused for an extended period, switch it off, defrost, clean, dry thoroughly, and leave the door open to prevent mould from developing.

### **Care & Cleaning:**

- Before carrying out any maintenance or cleaning, switch off the appliance and disconnect it from the mains supply.
- Do not clean the appliance using metal objects, as this may cause damage or injury.
- Do not use sharp objects to remove frost, as this may damage the appliance. Use a plastic scraper only.
- Regularly inspect the drain outlet in the refrigerator compartment for defrosted water. If necessary, clean the drain to prevent blockages.
- A blocked drain may cause water to collect at the bottom of the appliance. (\*if there is a fresh food storage compartment)

### **Installation:**

**IMPORTANT!** For the electrical connection, carefully follow the instructions provided in the relevant sections of this manual.

- Unpack the appliance and inspect it for any damage. Do not connect or use the appliance if it is damaged. Report any damage immediately to the retailer and retain the packaging for reference.

- Allow the appliance to stand upright for at least four hours before connecting it to the mains supply to let the compressor oil settle.
- Ensure there is adequate air circulation around the appliance. Insufficient ventilation may cause overheating. Follow the installation instructions to achieve proper airflow.
- Whenever possible, position the spacers against a wall to prevent contact with hot components, such as the compressor or condenser, and reduce the risk of burns.
- Do not place the appliance near radiators, cookers, or other heat sources.
- Ensure that the mains plug remains accessible after installation for safe disconnection.

### **Service:**

- Any electrical work required for servicing the appliance must be carried out by a qualified electrician or competent person.
- This appliance must be serviced by an authorized service centre, using only genuine spare parts.

### **Energy Saving:**

- Do not place hot food directly into the appliance.
- Avoid packing food too closely together, as this prevents proper air circulation.
- Ensure that food does not touch the back wall of the compartment(s).
- In the event of a power outage, do not open the door(s).
- Minimise the frequency of opening the door(s) during use.
- Do not leave the door(s) open for extended periods.
- Do not set the thermostat to colder than necessary.
- Keep all accessories, such as drawers, shelves, and balconies, in place to maintain energy efficiency.

### **Environment Protection:**

- This appliance does not contain gases that could harm the Ozone layer, either in its refrigerant circuit or insulation materials.
- Do not dispose of the appliance with regular household waste.
- The insulation foam contains flammable gases, so the appliance must be disposed of in accordance with local regulations. Contact your local authorities for guidance.
- Avoid damaging the cooling unit, particularly the heat exchanger, during handling or disposal.
- Materials marked with the recycling symbol  are recyclable and should be processed at the appropriate collection points.



The symbol on the product or its packaging indicates that this appliance must not be disposed of with household waste.

Instead, it should be taken to an authorized collection point for the recycling of electrical and electronic equipment.

Proper disposal helps prevent potential harm to the environment and human health that could result from inappropriate waste handling.

For more information about recycling this product, contact your local council, household waste disposal service, or the retailer where the product was purchased.

## **Packaging Materials**

The materials with the symbol are recyclable.

Dispose of all packaging in an appropriate recycling container to ensure proper recycling.

## **Disposal of Appliance**

1. Disconnect the mains plug from the power outlet.
2. Cut the mains cable and dispose of it safely.



### **WARNING:**

During the use, servicing, and disposal of the appliance, pay attention to the symbol shown (located on the rear of the appliance, either on the rear panel or compressor, in yellow or orange).

This is a risk of fire warning symbol. The refrigerant pipes and compressor contain flammable materials. Always keep the appliance away from open flames or other sources of ignition during use, servicing, and disposal.

**Product Overview:**

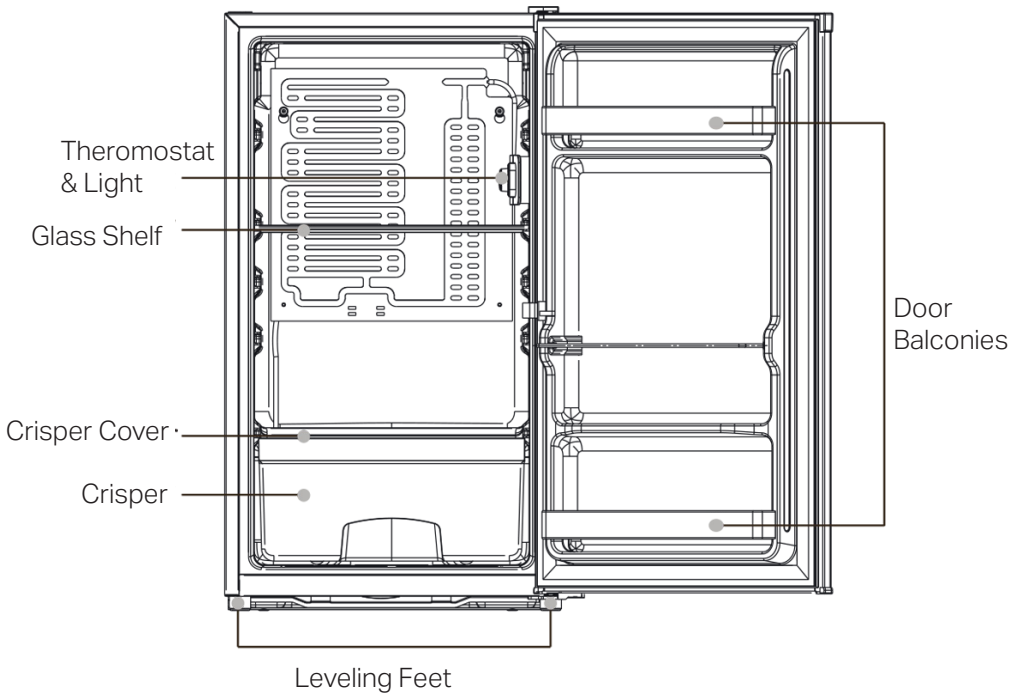

**Note:** This illustration is provided for guidance purposes only. For full installation details, please refer to your specific appliance instructions.

## Door Reversal:

Before reversing the door, ensure you have the following tools and materials ready:

- Straight (flathead) screwdriver
- Cross (Phillips) screwdriver
- Spanner
- All components included in the accessory bag

1. Ensure the appliance is unplugged and completely empty before starting.
2. To remove the door, the appliance must be tilted backwards. Support the unit on a stable and solid surface to prevent it from slipping during the door reversal process.
3. All removed parts should be retained, as they will be required for reinstalling the door.
4. Do not lay the appliance flat, as this may damage the cooling system.
5. It is recommended that two people carry out this procedure to ensure safety and prevent damage.
6. This refrigerating appliance is not designed for built-in installation.

### 1. Remove the top hinge

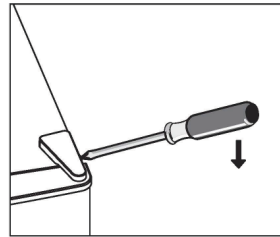

### 2. Undo the screws and remove the hinge bracket.

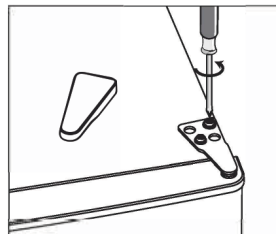

### 3. Remove the top left screw cover.

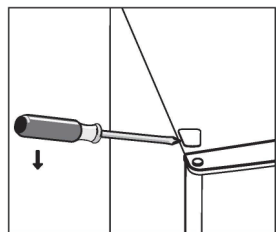

**4.** Move the core cover from the left side to the right side. Then lift the upper door and place it on a padded surface to prevent scratching.

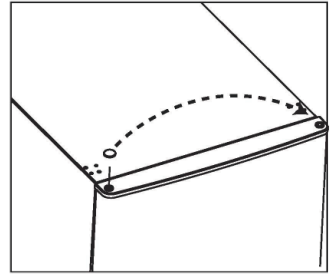

**5.** Unscrew and remove the bottom hinge pin, then flip the bracket over and replace it.

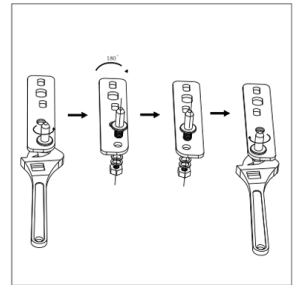
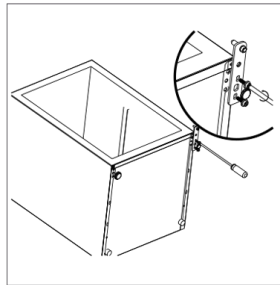

**6.** Reinstall the hinge bracket, securing the bottom hinge pin in place. Refit both adjustable feet.

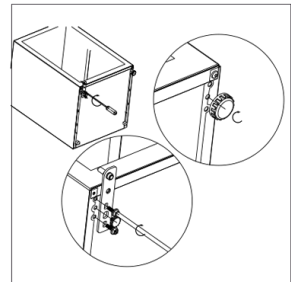

**7.** Place the door back on. Ensure the aligned horizontally and vertically so that the seals are closed on all sides before finally tightening the top hinge.

**8.** Insert the hinge bracket and screw it to the top of the unit.

**9.** Use the spanner to tighten if necessary.

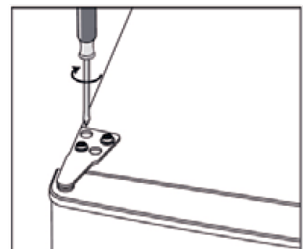

**10.** Put the hinge cover back on and screw back in.

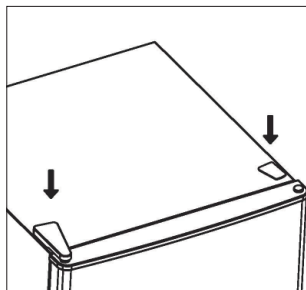

**11.** Detach the fridge door gaskets and then attach them after rotating.

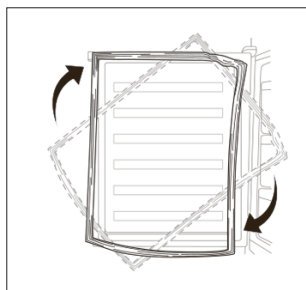

**Install External Door Handle:** \*(if external handle is present)

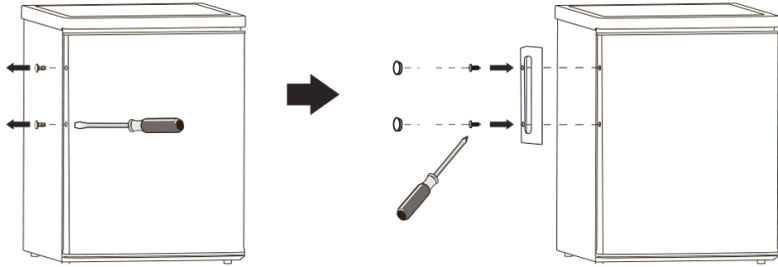

**Space Requirements:**

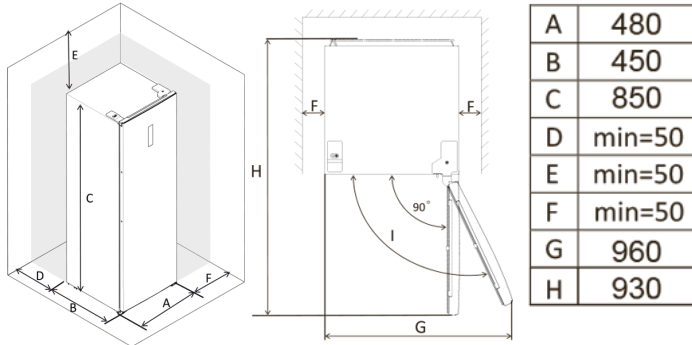

**Levelling the Unit:**

To level the appliance, adjust the two levelling feet at the front of the unit.

If the appliance is not level, the doors and magnetic seals may not align properly, affecting the seal and performance.

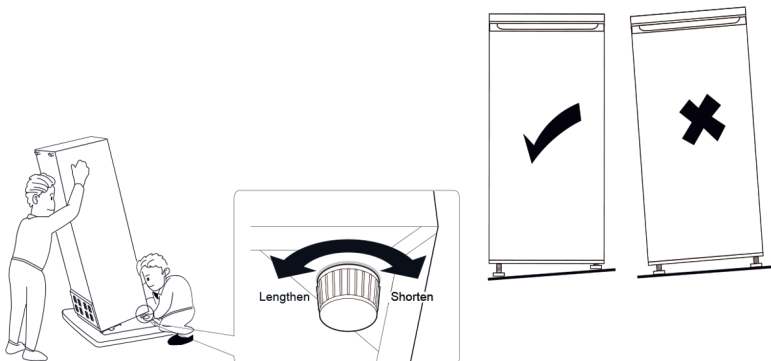

**Positioning:**

Install the appliance in a location where the ambient temperature matches the climate class indicated on the rating plate:

- Extended Temperate (SN): Suitable for ambient temperatures from 10°C to 32°C.
- Temperate (N): Suitable for ambient temperatures from 16°C to 32°C.
- Subtropical (ST): Suitable for ambient temperatures from 16°C to 38°C.
- Tropical (T): Suitable for ambient temperatures from 16°C to 43°C.

**Location:**

- Position the appliance well away from heat sources such as radiators, boilers, and direct sunlight.
- Ensure there is adequate airflow around the back of the cabinet to allow proper ventilation.
- For optimal performance, if the appliance is placed below an overhanging wall unit, maintain a minimum clearance of 50 mm between the top of the cabinet and the wall unit. Ideally, the appliance should not be installed under overhanging wall units.
- The appliance can be levelled accurately using one or more adjustable feet located at the base of the cabinet.
- This refrigerating appliance is not designed for built-in installation.



**WARNING:** The appliance must be easily disconnected from the mains power supply; therefore, the plug should remain accessible after installation.

**Electrical Connection:**

Before plugging in the appliance, ensure that the voltage and frequency indicated on the rating plate match your domestic power supply.

The appliance must be earthed. The power supply cable plug is equipped with an earth contact for this purpose. If your domestic power socket is not earthed, the appliance must be connected to a separate earth in accordance with current regulations. This should be carried out by a qualified electrician.

The manufacturer accepts no responsibility for damage or injury caused by failure to follow these safety precautions.

This appliance complies with E.E.C. Directives.

**Temperature Setting Recommendation:**

- Plug in the appliance. The internal temperature is controlled by a thermostat. There are three settings: MIN, NORMAL, and MAX. MIN is the warmest setting, and MAX is the coldest setting.
- The appliance may not operate at the correct temperature if the ambient temperature is particularly high or if the door is opened frequently.

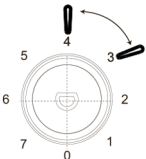
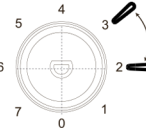
Temperature Setting Recommendation		
Environment Temperature	Freezer compartment	Fridge compartment
Summer	/	 <p>Set on 3~4</p>
Normal	/	 <p>Set on 3~4</p>
Winter	/	 <p>Set on 2~3</p>

\*The information above provides users with recommendations for temperature settings.

### Impact on Food Storage:

- Under recommended settings, the maximum storage time in the freezer is no more than one month.
- The storage time may be reduced when other settings are used.

### Daily Use:

Store different types of food in the appropriate compartments according to the table below.

Refrigerator compartments	Type of food
Door or balconies of fridge compartment	<ul style="list-style-type: none"><li>• Foods with natural preservatives, such as jams, juices, drinks, condiments.</li><li>• Do not store perishable foods.</li></ul>
Crisper drawer (salad drawer)	<ul style="list-style-type: none"><li>• Fruits, herbs and vegetables should be placed separately in the crisper bin.</li><li>• Do not store bananas, onions, potatoes, garlic in the refrigerator.</li></ul>
Fridge shelf – middle	<ul style="list-style-type: none"><li>• Dairy products, eggs</li></ul>
Fridge shelf – top	<ul style="list-style-type: none"><li>• Foods that do not need cooking, such as ready-to-eat foods, deli meats, leftovers.</li></ul>

### Daily Use:

#### Cleaning the Interior:

Before using the appliance for the first time:

1. Wash the interior and all internal accessories with lukewarm water and a small amount of neutral soap to remove any odours from manufacturing.
2. Rinse thoroughly and dry all surfaces completely.

Important: Do not use detergents, abrasive powders, or harsh cleaning agents, as these may damage the finish of the appliance.

Temperature Setting:

- Plug in the appliance. The internal temperature is controlled by a thermostat. There are 8 settings. 1 is the warmest setting and 7 is the coldest setting and 0 is off.
- The appliance may not operate at the correct temperature if the ambient temperature is particularly high or if the door is opened frequently.
- This refrigerator is not suitable for freezing food.

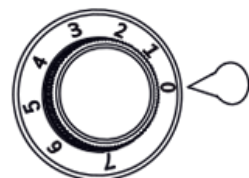

## Accessories:

### Moveable Shelves:

The walls of the refrigerator are fitted with a series of runners, allowing the shelves to be positioned as required.

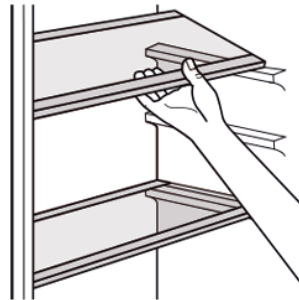

## Helpful Hints & Tips:

### Hints for Fresh Food Refrigeration:

#### To obtain the best performance:

- Do not store warm food or evaporating liquids in the refrigerator.
- Cover or wrap food, particularly items with a strong odour.

### Hints for Refrigeration:

- Meat (all types): Wrap in polythene bags and place on the glass shelves above the vegetable drawer. For safety, store in this way for no more than one or two days.
- Cooked foods and cold dishes: These should be covered and may be placed on any shelf.
- Fruit and vegetables: These should be thoroughly cleaned and placed in the special drawer provided.
- Butter and cheese: These should be placed in special airtight containers or wrapped in aluminium foil or polythene bags to exclude as much air as possible.
- Milk: Bottles or containers should have a cap and be stored in the door balconies.
- Bananas, potatoes, onions, and garlic, if not packaged, must not be stored in the refrigerator.

## Cleaning

For hygienic purposes, the interior of the appliance, including all internal accessories, should be cleaned regularly.



**Warning:** The appliance must not be connected to the mains during cleaning due to the risk of electrical shock.

- Before cleaning, switch off the appliance and disconnect the plug from the mains, or turn off the circuit breaker or fuse.
- Never use a steam cleaner, as moisture may penetrate electrical components, creating a risk of electrical shock.
- Hot vapours can also damage plastic parts.

- Ensure the appliance is completely dry before reconnecting it to the mains and returning it to service.

**Important!** Ethereal oils and organic solvents can damage plastic parts of the appliance. Examples include:

- Lemon juice or orange peel juice
- Butyric acid
- Cleaning agents containing acetic acid

Avoid contact of these substances with any plastic components.

- Do not allow acidic or solvent-based substances to come into contact with appliance parts.
- Do not use abrasive cleaners.
- Remove all food from the freezer and store in a cool, well-covered place.
- Switch off the appliance and disconnect the plug from the mains or turn off the circuit breaker or fuse.
- Clean the appliance and internal accessories using a soft cloth and lukewarm water. After cleaning, rinse with fresh water and dry thoroughly.
- Accumulation of dust on the condenser increases energy consumption. For this reason, carefully clean the condenser at the back of the appliance once a year with a soft brush or a vacuum cleaner. (\*if the condenser is at back of appliance)
- Once completely dry, reconnect the appliance and return it to service.

### Replacing the Lamp:

**CAUTION!** Before replacing the lamp, disconnect the appliance from the mains power supply.

The lamp specification is shown on the rating label.

Follow the steps below to replace the lamp:

1. Set the temperature control knob to position "0" to switch off the appliance.
2. Unplug the appliance to ensure it is completely disconnected from the mains power supply.
3. Remove the screw securing the lamp cover.
4. Pull out and remove the lamp cover.
5. Unscrew the lamp.
6. Fit the new lamp by following the reverse procedure, then refit the lamp cover and secure it with the screw.
7. Plug in the appliance and set the temperature control knob to the desired position.

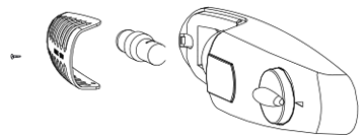

## Troubleshooting:



**CAUTION!** Before performing any troubleshooting tasks, disconnect the appliance from the power supply.

- Any troubleshooting not covered in this manual must be carried out only by a qualified electrician or competent person.

**Important:** Some operational sounds, such as the compressor running or refrigerant circulating, are normal and do not indicate a fault.

Problem	Possible cause	Solution
Appliance does not work	Temperature regulation knob is set at number "0".	Set the knob at other number to switch on the appliance.
	Mains plug is not plugged in or is loose	Insert mains plug.
	Fuse has blown or is defective	Check fuse, replace if necessary.
	Socket is defective	Mains malfunctions are to be corrected by an electrician.
The food is too warm.	Temperature is not properly adjusted.	Please look in the initial Temperature Setting section.
	Door was open for an extended period.	Open the door only as long as necessary.
	A large quantity of warm food was placed in the appliance within the last 24 hours.	Turn the temperature regulation to a colder setting temporarily.
	The appliance is near a heat source.	Please look in the installation location section.
Appliance cools too much	Temperature is set too cold.	Turn the temperature regulation knob to a warmer setting temporarily.
Unusual noises	Appliance is not level.	Re-adjust the feet.
	The appliance is touching the wall or other objects.	Move the appliance slightly.
	A component, e.g. a pipe, on the rear of the appliance is touching another part of the appliance or the wall.	If necessary, carefully bend the component out of the way.
Water on the floor	Water drain hole is blocked.	See the Cleaning and Care section.
Side panels are hot.	It's normal. Heat exchange parts are in the sides.	Take gloves to touch sides.

If the problem persists, contact the authorized Service Centre.

To ensure a quick and accurate service, have the following information ready (refer to the appliance rating plate):

- Model number
- Serial number
- Date of purchase

# Product Fiche

Model identifier: <b>MDAUCL48W</b>					
Parameter		Value		Parameter	Value
Overall dimensions (millimetre)	Height	850		Total volume (dm <sup>3</sup> or l)	90
	Width	475			
	Depth	445			
EEI		100		Energy efficiency class	E
Airborne acoustical noise emissions (dB(A) re 1 pW)		37		Airborne acoustical noise emission class	C
Annual energy consumption (kWh/a)		85		Climate class:	extended temperate, subtropical
Minimum ambient temperature (°C), for which the refrigerating appliance is suitable		10		Maximum ambient temperature (°C), for which the refrigerating appliance is suitable	38
Winter setting		No			
<b>Compartment Parameters:</b>			<b>Compartment parameters and values</b>		
Compartment type		Compartment Volume (dm <sup>3</sup> or l)	Recommended temperature setting for optimised food storage (°C) These settings shall not contradict the storage conditions set out in Annex IV, Table 3	Freezing capacity (kg/24h)	Defrosting type (Auto-Defrost=A, Manual Defrost=M)
Pantry	No	-	-	-	-
Wine storage	No	-	-	-	-
Cellar	No	-	-	-	-
Fresh food	Yes	90	4	-	M
Chill	No	-	-	-	-
1-star	No	-	-	-	-
2-star	No	-	-	-	-
3-star	No	-	-	-	-
4-star	No	-	-	-	-
Fast freeze facility		No			
Type of light source		N/A			
Minimum duration of the guarantee offered by the supplier: 24 months					
Weblink to the supplier's website, where the information in point 4 of Annex II of Commission Regulation (EU)2019/2019 is found: <a href="https://www.montpellier-appliances.com/product-details/montpellier-mdaucl48w-undercounter-larder-fridge-in-white/">https://www.montpellier-appliances.com/product-details/montpellier-mdaucl48w-undercounter-larder-fridge-in-white/</a>					

# Here For You

---

## Here For You

### After-sales assistance

If you continue to experience problems with your appliance, please call the Montpellier customer service helpline on: 03333 234473 opt 3

Please have all your product details available, including the model number, serial number, original sales invoice (clearly showing model number, date of purchase and your retailer's details) before registering a fault.

The service call cannot progress without this information.

### Your 2 year Manufacturer's guarantee

THIS DOES NOT AFFECT YOUR STATUTORY RIGHTS.

Your new Montpellier appliance carries a free guarantee which protects you against the cost of repairs during the first 24 months from date of purchase provided that:

Any claim is accompanied by evidence of the model reference, model serial number and proof of purchase, such as a Sales Receipt, showing that the appliance was purchased within the 24 months prior to the date of claim.

### What is not covered under the Guarantee

- Any appliance not correctly installed and operated in accordance with the manufacturer's instructions
- Any appliance that is used for anything other than domestic purposes.
- Any defect caused by accident, misuse, unauthorised modification or inexpert repair.
- Cost of Call-out where a fault cannot be found with the appliance. Cost of Call-out for work covering routine maintenance, such as, but not exclusively, cleaning of filters or defrosting.

- Cost of Call-out for work required to correct the alignment of doors following door reversal procedures carried out by you. Use of the appliance by anyone other than the Householder. Use in any commercial environment.
- Consumable items, such as, but not exclusively, fuses in plugs, bulbs and breakable items which require routine replacement. Repair costs incurred that have not been authorised by Montpellier service and/or carried out by a non-approved Montpellier engineer.
- Montpellier Appliances do not accept claims for consequential loss, rusting, corroding, delivery damage or scratches.

YOUR GUARANTEE IS VALID ONLY IN THE UK & THE REPUBLIC OF IRELAND

To register your appliance simply complete the card in your appliance pack and return it with a stamp affixed or alternatively you can register online at:

[montpellier-appliances.com/support](http://montpellier-appliances.com/support)

...or by phone, call our warranty registration department on **08081 961 388**

### SERVICE HELP -LINE

Should your appliance develop a fault, please call the Montpellier customer service helpline on:

**03333 234473 opt 3**

Please remember to have all your product details available, including the model number, serial number, date of purchase and your retailer's details before registering a fault.





**Montpellier Domestic Appliances Ltd.**

Unit 1, Tewkesbury Retail Park, Northway Lane,  
Tewkesbury, Gloucestershire GL20 8UY

**[www.montpellier-appliances.com](http://www.montpellier-appliances.com)**



The symbol on the product or on its packaging indicates that this product may not be treated as household waste. Instead it shall be handed over to the applicable collection point for the recycling of electrical and electronic equipment. By ensuring this product is disposed of correctly, you will help prevent potential negative consequences for the environment and human health, which could otherwise be caused by inappropriate waste handling of this product. For more detailed information about recycling of this product, please contact your local city office, your household waste disposal service or the shop where you purchased the product.